

Wireless flat panel detector **XenOR 24CW**

25 x 30 cm [10 x 12 Zoll]

The compact and robust XenOR 24CW detector in a splash proof aluminum case and shock absorbing rubber edges has been designed specially for outdoor use. It is of course equally suited for stationary radiology examinations.

The wireless detector offers freedom of movement and takes only about 4 seconds to acquire and transmit an image. The detector with "CsI direct deposition" technology offers excellent image quality and low noise.

- Due to the automatic synchronisation of detector and generator by means of AED there is no need to modify the X-ray system or adapt the system or the cable connections
- Extra long battery life with 1400 shots/charge (10 second interval between shots) and 7-hours standby time
- Active area 24.4 x 30.7 cm [10" x 12"]
- Pixel pitch 120 μ m
- Pixel array 2560 x 2048 Pixel
- Resolution approx. 4,16 lp/mm
- Dimensions (W x H x D) 333 x 282 x 15 mm
- Weight approx. 2,3 kg

XenOR - The art of digital X-ray imaging



Wireless flat panel detector

XenOR 24CW 25 x 30 cm, [10 x 12 inch]

Parameter

Sensor	
Scintillator	Direct Deposit: Tl
Active Area	307.2 x 244.32 mm
Pixel Array	2560 x 2048
Pixel Pitch	120 μ m

Image Quality	
Limiting Resolution	4.16 lp/mm
MTF	~ 70% (@ 1 lp/mm)
	~ 40% (@ 2 lp/mm)
	~ 25% (@ 3 lp/mm)
	~ 15% (@ 4 lp/mm)
DQE	(@RQA5, 14 μ Gy)
	~ 70% (@ 0 lp/mm)
	~ 33% (@ 3 lp/mm)
Sensitivity	~ 0.62ct/nGy
Response Non-linearity	< \pm 0.5%
Maximum Linear Dose	> 95 μ Gy
Dark Noise	~ 10 nGy
Dynamic Range	~ 82 dB
Greyscale	16 bits

Communication Interface	
Communication Interface	Gigabit Ethernet 2.4/5 GHz, 300 Mbps
Image Acquisition Time	2-3 s
Exposure Control	AED and Manual Sync

Environmental	
Operating	
- Temperature Range	5°C - 35°C
- Humidity Range (Non condensing)	30% - 75% RH
Storage	
- Temperature Range	-20°C - 55°C
- Humidity Range	10% - 90% RH
- Water/Dust Proof	IP 64

Mechanical	
Dimension	333 x 282 x 15 mm
Weight	ca. 2.3 kg
Housing Material	Carbon fiber front Aluminium alloy (back)

Power	
Maximum Power	<8W (standby) / 12W (operating)
Power Supply	100 - 250V AC
Frequency	50/60Hz
Battery	3260 mAh, 14.8 V

Please visit www.or-technology.com for more details

Specifications subject to revision without notice

The editor strives to impart correct and up to date information. The provided specifications are based on current knowledge and are subject to revision without notice. This brochure is subject to correction. The editor assumes no responsibility for the information being up to date, correct and complete. All furnished logos, pictures and graphics are property of the particular company and subject to copyright of the licensor. Use, dissemination, distribution or copying of the pictures, logos or text compiled or processed by the editor is subject to our written consent. All rights reserved.

Headquarters: OR Technology (Oehm und Rehbein GmbH), 18057 Rostock, Germany, Neptunallee 7c
 Info-Hotline: +49 381 36 600 600, info@or-technology.com, www.or-technology.com
OR Technology UK: Celtic SMR Ltd., Frederick House, Hayston View, Johnston, Haverfordwest, Pembrokeshire SA62 3AQ, United Kingdom, www.celticsmr.co.uk, sales@celticsmr.co.uk

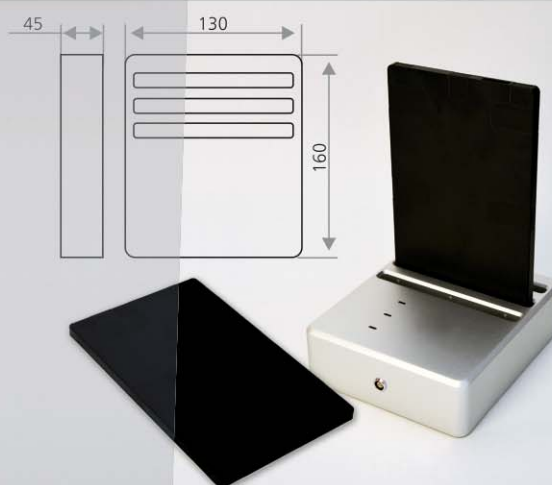

Battery charger with batteries

